

COPYRIGHT © W.K. DICKSON, INC. ALL RIGHTS RESERVED. REPRODUCTION OF THIS DOCUMENT, EITHER WHOLLY OR IN PART, WITHOUT THE WRITTEN PERMISSION OF W.K. DICKSON, INC. IS STRICTLY PROHIBITED. THIS DOCUMENT IS UNLAWFUL TO BE REPRODUCED IN ANY MANNER WITHOUT THE WRITTEN PERMISSION OF W.K. DICKSON, INC. FILED WITH THE PUBLIC ACCESS SYSTEM ON 08/08/2018 AT 10:00:00 AM BY [REDACTED]



WK DICKSON
community infrastructure consultants

1320 MAIN STREET
SUITE 400
COLUMBIA, SC 29201
(803) 786-4261
(803) 786-4263
WWW.WKDICKSON.COM

PROFESSIONAL SEAL

NO.	DATE	DESCRIPTION

REVISION RECORD

PROJECT NAME: **WEDDINGTON ACRES SUBDIVISION**
TOWN OF WEDDINGTON, SANDY RIDGE TOWNSHIP, UNION COUNTY, NC

DRAWING TITLE: **SALES MAP**

PROJ. MGR.:
DESIGN BY:
DRAWN BY:
PROJ. DATE:
DRAWING NUMBER:

1.0

WKD PROJ. NO.: **20160191.00.CL**

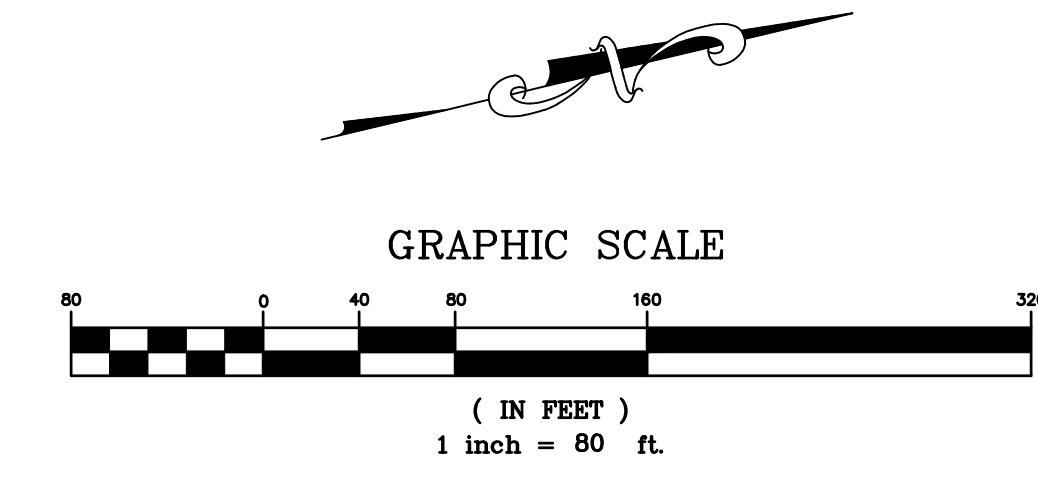

PRELIMINARY DESIGN - NOT RELEASED FOR CONSTRUCTION, RECORDATION, CONVEYANCES, OR SALES

COPYRIGHT © 2019, W.K. DICKSON, INC. ALL RIGHTS RESERVED. REPRODUCTION OR USE OF THE CONTENTS OF THIS DOCUMENT, ABSTRACTED OR IN WHOLE OR IN PART, WITHOUT THE WRITTEN PERMISSION OF W.K. DICKSON, INC. IS STRICTLY PROHIBITED. THE MATERIAL IS PROVIDED AS IS, WITHOUT WARRANTY OF ANY KIND, EXPRESS OR IMPLIED, INCLUDING BUT NOT LIMITED TO THE WARRANTIES OF MERCHANTABILITY AND FITNESS FOR A PARTICULAR PURPOSE. THE USER SHALL BE RESPONSIBLE FOR THE ACCURACY OF THE INFORMATION PROVIDED HEREIN.



1320 MAIN STREET
 SUITE 400
 COLUMBIA, SC 29201
 (803) 786-4261
 (803) 786-4263
 WWW.WKDICKSON.COM

PROFESSIONAL SEAL

NO.	DATE	DESCRIPTION

PROJECT NAME: **WEDDINGTON ACRES SUBDIVISION**
 TOWN OF WEDDINGTON, SANDY RIDGE TOWNSHIP, UNION COUNTY, NC
 DRAWING TITLE: **SALES MAP**

PROJ. MGR.:
 DESIGN BY:
 DRAWN BY:
 PROJ. DATE:
 DRAWING NUMBER:
1.0
 WKD PROJ. NO.:
 20160191.00.CL

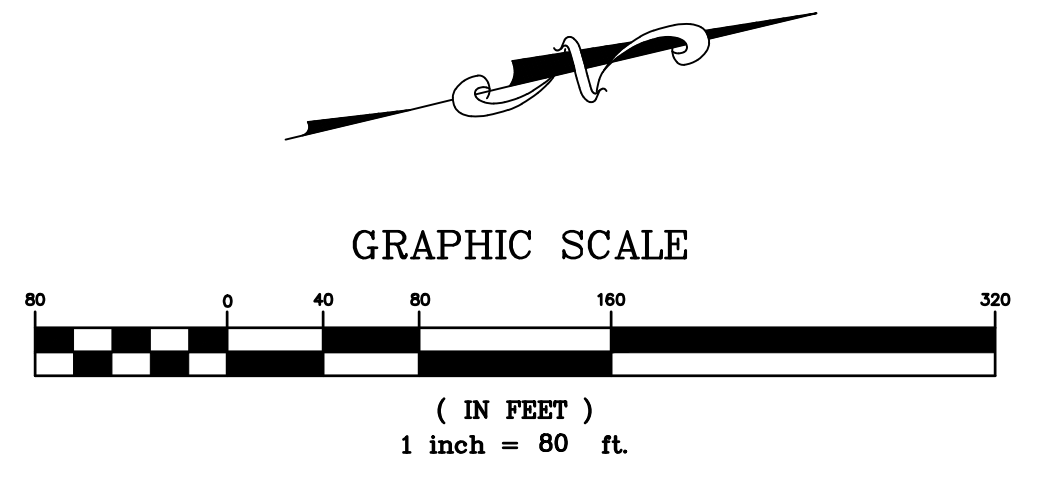

PRELIMINARY DESIGN - NOT RELEASED FOR CONSTRUCTION, RECORDATION, CONVEYANCES, OR SALES

COPYRIGHT © W.K. DICKSON, INC. ALL RIGHTS RESERVED. REPRODUCTION OR USE OF THE CONTENTS OF THIS DOCUMENT, ABSENCE OF THE ORIGINAL OR THE ORIGINAL DESIGN, SHALL BE PROHIBITED TO THE FULL EXTENT OF THE LAW.

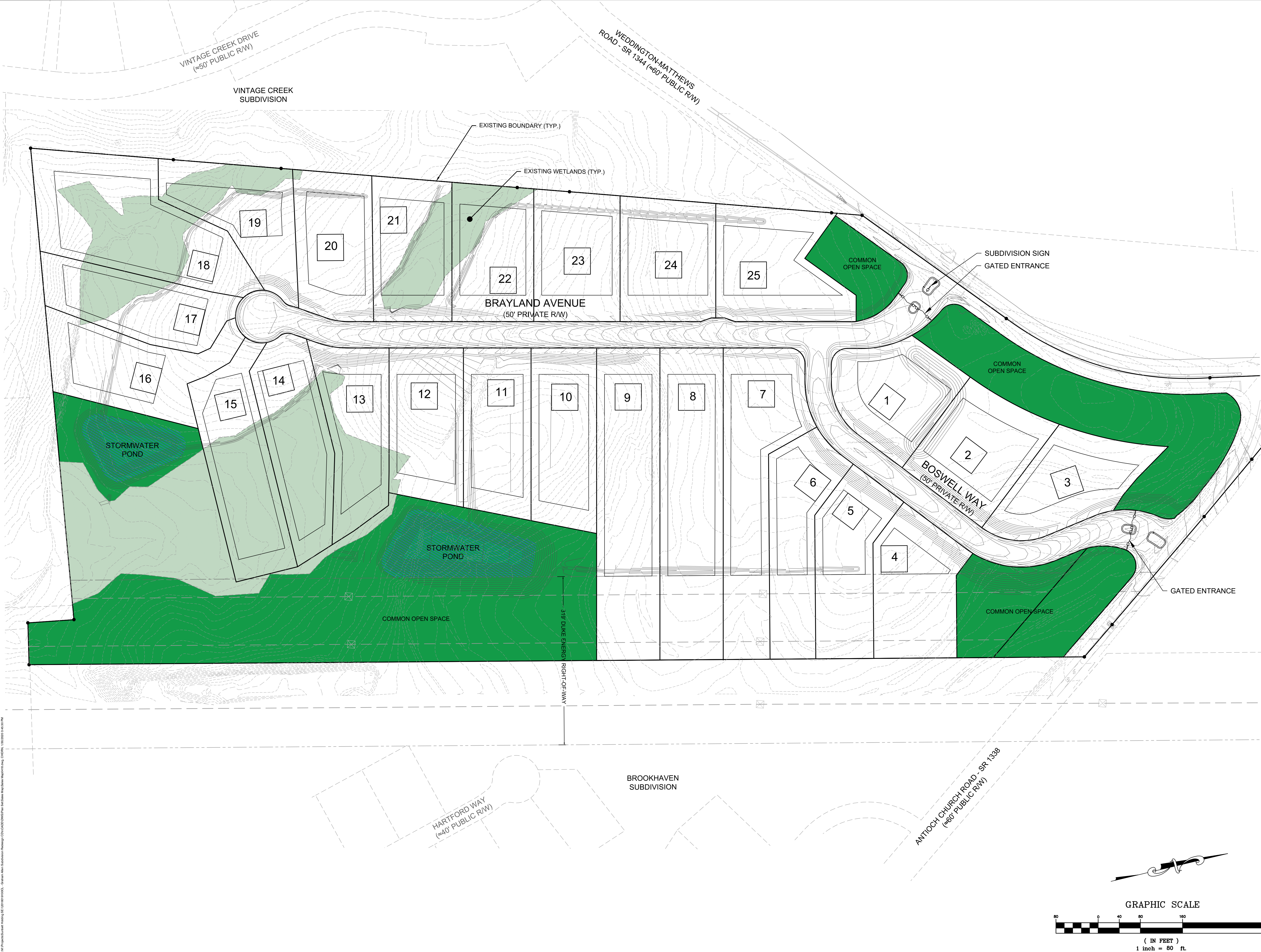

WK DICKSON
 community infrastructure consultants
 1320 MAIN STREET
 SUITE 400
 COLUMBIA, SC 29201
 (781)803-786-4261
 (781)803-786-4263
 WWW.WKDICKSON.COM

PROFESSIONAL SEAL

NO.	DATE	DESCRIPTION

PROJECT NAME: **WEDDINGTON ACRES SUBDIVISION**
 TOWN OF WEDDINGTON, SANDY RIDGE TOWNSHIP, UNION COUNTY, NC
 DRAWING TITLE: **SALES MAP**

PROJ. MGR.:
 DESIGN BY:
 DRAWN BY:
 PROJ. DATE:
 DRAWING NUMBER:
1.0
 WKD PROJ. NO.:
 20160191.00.CL

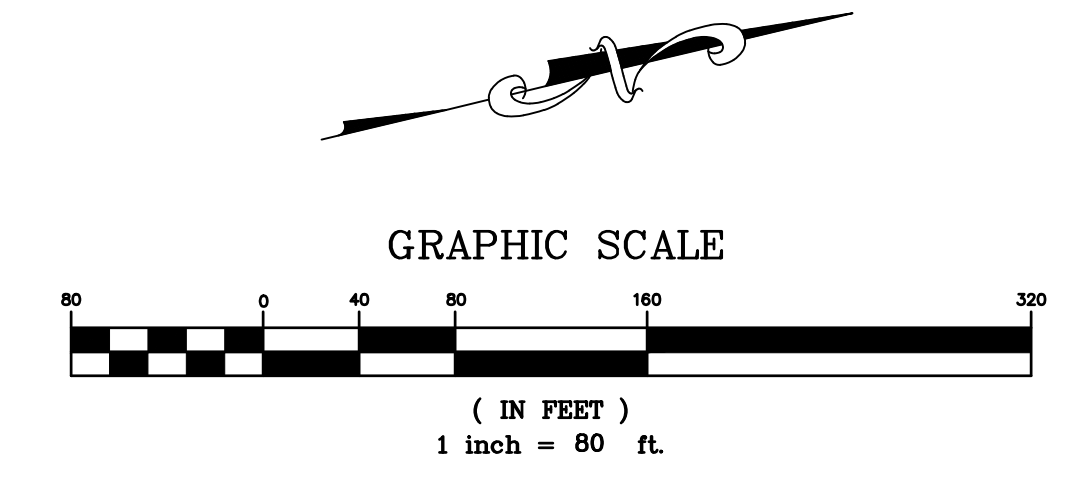

PRELIMINARY DESIGN - NOT RELEASED FOR CONSTRUCTION, RECORDATION, CONVEYANCES, OR SALES

COPYRIGHT © W.K. DICKSON, INC. ALL RIGHTS RESERVED. REPRODUCTION OR USE OF THIS DOCUMENT, ABSORPTION OF THE INFORMATION HEREIN, OR ANY PART THEREOF, IN ANY MANNER WITHOUT THE WRITTEN PERMISSION OF W.K. DICKSON, INC. SHALL BE PROHIBITED. THE INFORMATION CONTAINED HEREIN IS UNCLASSIFIED AND IS AVAILABLE TO THE PUBLIC.



WK DICKSON
community infrastructure consultants
1320 MAIN STREET
SUITE 400
COLUMBIA, SC 29201
(803) 786-4261
(803) 786-4263
WWW.WKDICKSON.COM

PROFESSIONAL SEAL

NO.	DATE	DESCRIPTION

PROJECT NAME: **WEDDINGTON ACRES SUBDIVISION**
TOWN OF WEDDINGTON, SANDY RIDGE TOWNSHIP, UNION COUNTY, NC
DRAWING TITLE: **SALES MAP**

PROJ. MGR.:
DESIGN BY:
DRAWN BY:
PROJ. DATE:
DRAWING NUMBER:
1.0
WKD PROJ. NO.:
20160191.00.CL

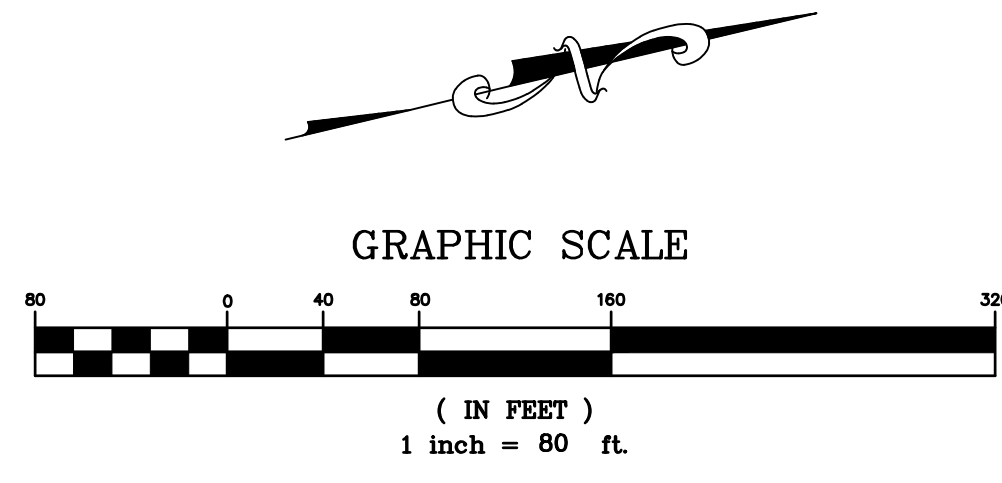

PRELIMINARY DESIGN - NOT RELEASED FOR CONSTRUCTION, RECORDATION, RECORDED, CONVEYANCES, OR SALES